

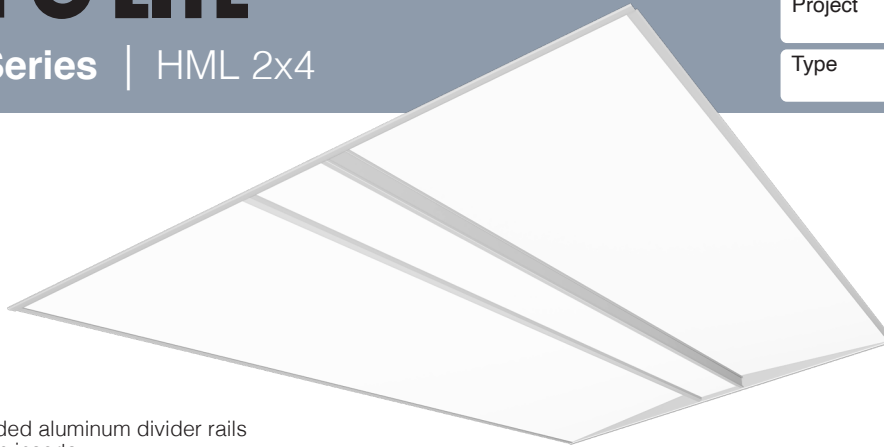

Harmony Series | HML 2x4

Date	Notes
Project	
Type	Qty



Features

Steel housing, extruded aluminum divider rails w/specular aluminum inserts.

LED optimized optics for smooth even illumination without glare.

For installation in a wide variety of suspended grid ceilings including Slot Grid and Tegular, and drywall.

High efficiency driver for custom lumen packages. 0-10V dimming to 1% standard.

High efficacy LEDs in 80 or 90 CRI; two or three channel tunable white; tunable color.

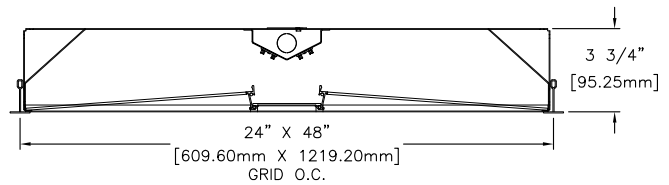

Ordering Guide

MODEL	OPTICS	CCT ¹	LUMENS ²	SIZE	MOUNTING ³	FINISH	OPTIONS
HML-D				24			
HML-D Direct	<p>A-SI = Angled Satin Ice acrylic side lenses (shown)* F-SI = Flat Satin Ice acrylic side lenses</p> <p>*A-SI optic only is DLC qualified.</p>	<p>27 = 2700K 80CRI 30 = 3000K 80CRI* 35 = 3500K 80CRI* 40 = 4000K 80CRI* 50 = 5000K 80CRI</p> <p>90 CRI add *9" Ex: 940 = 4000K @ 90 CRI</p> <p>TUNABLE WHITE & COLOR¹</p> <p><u>2-Channel White</u> 2DIM10 = for 0-10V 2DALI = for DALI 2DMX = for DMX 2PSQ = for Lutron 2SNS = for Signify 2CAS = for Casambi</p> <p><u>3-Channel White</u> 3DML = for DLM</p> <p><u>3-Channel Color RGB</u></p> <p><u>4-Channel Color/White RGBW</u></p> <p><u>5-Channel Color/Warm White/Cool White RGBWW</u></p> <p>*Only 30/35/40K CCT at 80CRI are DLC qualified.</p>	<p>STANDARD</p> <p>VLO = 3800L (30W, 127LPW) LO = 5100L* (40W, 127LPW) SO = 6040L* (56W, 120LPW) HO = 7550L (70W, 108LPW) VHO = 9435L (88W, 107LPW)</p> <p>*LO & SO only are DLC qualified.</p> <p>Consult factory for additional lumen packages.</p> <p>All values are nominal.</p>	24 = 2x4	<p>G = Grid 15/16" T-Bar MG = Mini Grid 9/16" T-Bar SG = Slot Grid 9/16" T-Bar XG = Interlude 9/16" T-Bar TGF = Tegular Flush 15/16" T-Bar MTGF = Mini Tegular Flush 9/16" T-Bar SGF = Slot Grid Flush 9/16" T-Bar XGF = Interlude Flush 9/16" T-Bar S = Surface F = Flange</p> <p>See all mounting options page 2.</p>	<p>W = White CC = Custom Color AMW = Anti-Microbial White AMW finish contains SilverSan™ ionic silver to inhibit the growth of bacteria.</p>	<p>DIMMING DRIVERS DIM10 = 0-10V (1.0%) - Standard DIMSR = 0-10V (5.0%) Sensor Ready DIMST = Step Dimming (40%/100%) DALI = DALI (5.0%)</p> <p>LUTRON™ DIMMING DRIVERS LDE1 = Hi-Lume™ 1% EcoSystem™ LDE5 = 5-Series 5% EcoSystem™ L3DA3W = Hi-Lume™ 1% 3-Wire LTEA2W = Hi-Lume 1% 2-Wire 120V</p> <p>SENSORS & CONTROLS ESN = Philips™ EasySense DAY = Daylight Harvesting OCC = Occupancy Sensor CAS = Casambi Bluetooth control VDO = Vive Sensor by Lutron</p> <p>EMERGENCY EMC = Emergency Circuit GTD = Generator Transfer Device EPC4 = 4W Emergency Battery Pack EPC7 = 7W Emergency Battery Pack EPC10 = 10W Emergency Battery Pack EPC12 = 12W Emergency Battery Pack</p>

DLC Options include A-SI Optics, 30/35/40KCCT @ 80CRI, and LO and SO lumen packages.

¹Tunable white, tunable color and RGB/W options detailed on page 3.

²Delivered Lumens are Standard Output (SO) and Low Output (LO) at 80+CRI 4000K CCT. Use the following multiplier to estimate delivered lumens at other CCTs: 2700K = 0.94, 3000K = 0.96, 3500K = 0.98, 5000K = 1.02. All values nominal. See page 2 for photometry.

³See page 2 for ceiling mounting options details and full specifications.



Mounting Options

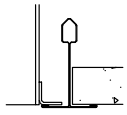

15/16" T-Bar (G)

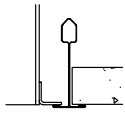

9/16" T-Bar (MG)

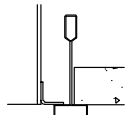

Slot Grid (SG)

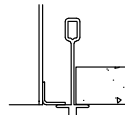

Interlude (XG)

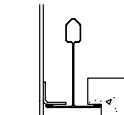

15/16" Tegular Flush (TGF)

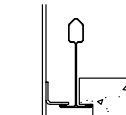

9/16" Tegular Flush (MTGF)

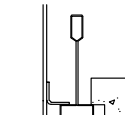

Slot Grid Flush (SGF)

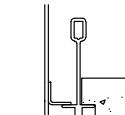

Interlude Flush (XGF)

Drywall Ceiling

Mounting Detail

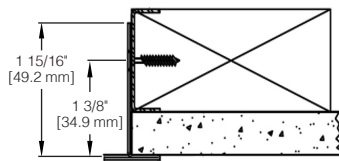

Flange Kit for drywall ceilings available:

- FK-14 for 1x4
- FK-22 for 2x2
- FK-24 for 2x4
- FK-44 for 4x4

Grid Ceiling

Five-step Universal Installation Sequence.

Complete Installation Instructions for grid and drywall ceiling types are available at: www.dayolite.com

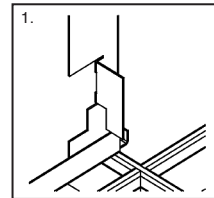

Position Fixture

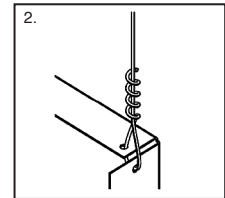

Secure Tie Wire

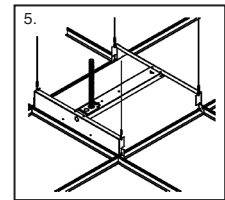
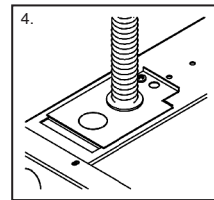
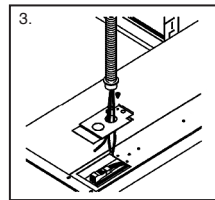

Photometry

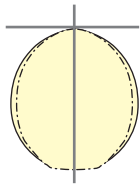

HML-A-D-SI-40-VLO-24

CCT: 4000K
WATTS: 30
LUMENS: 3800
LPW: 127
Distribution: 100% Direct

HML-A-D-SI-40-SO-24

CCT: 4000K
WATTS: 56
LUMENS: 6040
LPW: 120
Distribution: 100% Direct

HML-A-D-SI-40-VHO-24

CCT: 4000K
WATTS: 88
LUMENS: 9435
LPW: 107
Distribution: 100% Direct

HML-A-D-DP-SI-LO-24

CCT: 4000K
WATTS: 40
LUMENS: 5100
LPW: 127 LPW
Distribution: 100% Direct

HML-A-D-SI-40-HO-24

CCT: 4000K
WATTS: 70
LUMENS: 7550
LPW: 108
Distribution: 100% Direct

Specifications

CONSTRUCTION: 20 gauge CRS housing and internal components. Extruded aluminum divider rails with specular aluminum inserts.

REFLECTOR: 20 gauge CRS finished in highly reflective baked white enamel with pre-finished reflective LED tray.

OPTICS: LED optimized Satin Ice (SI) acrylic lay-in lenses.

LED: LED modules in 27/30/35/40 & 50K CCT, 80 CRI (90CRI available). Lumen maintenance $L_{70} = 50,000$ hours. 3 SDCM color consistency.

DRIVER: Standard Class 2 AOC 0-10V to 1%, 120/277V input, PF > 90%, THD < 20 @ 120V. Additional dimming protocols available. All drivers prewired from factory for connection to control system (by others). -20°C to +50°C operating range. FCC Title 47 Part 15 Class A electromagnetic compliance. <24dB Class A sound rating. Field replaceable.

MOUNTING: Typical installation is in an exposed inverted T-bar ceiling. Fixtures are supplied with four support brackets for additional support to T-bar. May also be installed in a plaster ceiling (F option with Flange).

FINISH: Housing and components finished in baked white enamel. SilverSan™ antimicrobial finish also available.

CERTIFICATION: Luminaires are cETLus listed conforming to UL STD. 1598 and certified to CSA STD C22.2 NO. 250.0. Suitable for dry & damp locations. Union Made in the United States of America. I.B.E.W. RoHS compliant.

Day-O-Lite offers a variety of tunable white and tunable color options for a range of human centric applications and budgets. It is recommended that a recognized authority on the benefits and best practices of tunable white be consulted prior to specification. As a rule, fewer channels will provide a basic level of performance for budget conscious applications. Conversely, an increased number of channels, a wider CCT range, higher CRI and more precise color consistency may be more appropriate depending on the application and desired results.

HOW TO SPECIFY

Select from the various channel/control options below and insert desired **Ordering Code** into the **COLOR TEMP** column of the Ordering Guide on page 1. No need to add a dimming option as the codes include the chosen protocol.

2-CHANNEL TUNABLE WHITE OPTIONS

2700K - 6500K CCT range
 1000L/ft LED modules @ 4000K
 80+ CRI w/3SDCM color accuracy
 10W/ft. nominal power

Ordering Codes

2DIM10 for 0-10V control
2DALI for DALI control
2DMX for DMX control
2PSQ for Lutron Quantum control
2SNS for control via Signify SNS sensors
2CAS for control via Casambi BLE wireless devices

LEGRAND BLANCO MULTI-CHANNEL OPTIONS

Blanco-2

Blanco-2 mixes two channels of white LEDs to approximate the blackbody curve for tunable white applications. CCT and intensity may be adjusted with controls by others.

3000K-5000K CCT range
 1000L/ft LED modules @ 4000K
 90+ CRI w/2SDCM color accuracy
 10W/ft. nominal power

Ordering Codes

B2DLM for DLM control

Blanco-3

Blanco-3 mixes three channels of white LEDs across a wider range of color temperatures for more demanding tunable white applications. CCT and intensity may be adjusted with controls by others.

2700K-6500K CCT range
 1000L/ft. LED modules @ 4000K
 90+ CRI w/SDCM color accuracy
 10W/ft. nominal power

Ordering Codes

B3DLM for DLM control

RGB & RGBW TUNABLE COLOR

RGB = Red, Green, Blue color mixing LEDs
 RGB/W = Red, Green, Blue + White of chosen CCT
 Dimming from 100% to 1%.
 90+ CRI w/3SDCM color accuracy
 10W/ft. nominal power

Notes:

RGB requires an RGB DMX or DALI controller (by others)

RGBW requires an RGBW DMX or DALI controller (by others)

All channels on one driver is standard, if isolating the White from the RGB channels is desired please consult factory.

RGB and RGBW are not recommended for tunable white applications.

Ordering Codes

RGB for DMX control
RGB27 for DMX control w/2700K white
RGB30 for DMX control w/3000K white
RGB35 for DMX control w/3500K white
RGB40 for DMX control w/4000K white
RGB50 for DMX control w/5000K white
RGB65 for DMX control w/6500K white
 Add Suffix **DAL** for DALI Control to codes above.

5-CHANNEL TUNABLE WHITE AND COLOR

RGBWW = Red, Green, Blue, Warm White, Cool White.
 Consult factory for RGBWW tunable white/color options.

Day-O-Lite makes no claims as to the psychological or physiological efficacy of the white color tuning options offered herein.